

# *SLENDERWALL*<sup>®</sup>

Architectural Precast Concrete/Steel Stud Building Panels

[www.slenderwall.com](http://www.slenderwall.com)

*Combining Time-Tested Components for Unlimited  
Design Freedom, Unmatched Product Life  
and Unequaled Savings.*

*SLENDERWALL*<sup>®</sup> Provides More  
LEED Credits than Competing Products.

Virginia's Tallest  
Building,  
38 stories



Westin Luxury Hotel and Residences,  
Virginia Beach, VA; Architect: BBG-BBGM



# SLENDERWALL® 5 “Must Have” cladding technologies for today’s owners.

Available **only** with the SLENDERWALL® panel system:

Architects & Engineers say SLENDERWALL® is “the most significant exterior wall system developed in 40 years.”

## 1 H<sub>2</sub>OUT™

In the Caulk Joint Drainage & Street-Level Leak Detection System

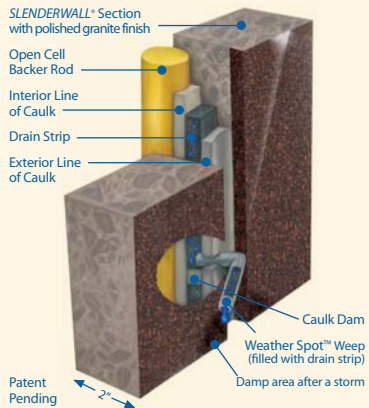

H<sub>2</sub>Out™ is the **only** secondary drainage, street-level, caulk joint leak detection system. If your caulk joints ever fail, leaks exit to the outside of the building and can be located within 20 feet of the failure.  
**Benefit:** early detection if caulk joints ever leak

## 2 DURAFLEX 360™

Differential Movement Technology

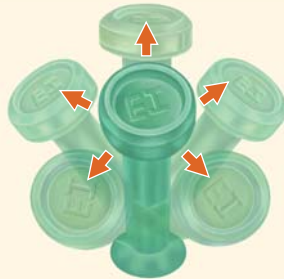

DuraFlex 360™ is the **only** precast to stud frame connection that allows 360° movement to isolate the precast concrete skin from structural stresses (wind loading, frame movement, expansion, contraction, and seismic shock). DuraFlex 360™ has passed applicable ASTM and AAMA test methods including AAMA 501.4.  
**Benefit:** structural integrity and water tightness

## 3 LIFT-AND-RELEASE™

Fast Panel-Landing System

Lift-and-Release™ is the **only** panel-landing system that makes the installation process faster and easier (19 minutes per panel).  
**Benefit:** increases panel installation rates by 50%



## 4 SECOND NATURE™

Architectural Precast Concrete Brick

Second Nature™ is the **only** “Class A” Architectural Precast Concrete Brick finish with the quality level necessary for “Class A” commercial projects.  
**Benefit:** no leaking brick joints



Heavy-gauge galvanized or stainless-steel stud accommodates interior finish  
Hot-dipped galvanized reinforcing  
High-strength architectural precast concrete, 2-inch thick with high-end fiber for extra strength  
1/2-inch air space reduces thermal transfer  
Available in a variety of colors, textures and finish combinations

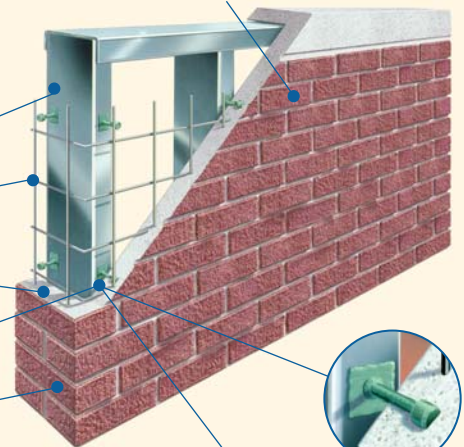

## 5 THERMAGUARD™

Thermal-Break / Air Barrier Precast Concrete System

ThermaGuard™ is the **only** 100% thermal-break/air barrier precast system. The connection consists of thermal-break protection created by both the 1/2-inch air space between the concrete panel and stud, and the exclusive epoxy-coated stainless-steel Nelson® anchor. The patented connection prevents corrosion and reduces thermal transfer by as much as 25%.  
**Benefit:** reduced heating and cooling costs

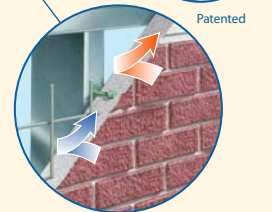

# **SLENDERWALL®** It's true! It will make a permanent change in the way you design.



The **SLENDERWALL®** panel system ends your search for an exterior cladding system that will eliminate wall failures forever.

- **Reduces structural steel and foundation requirements** when compared to conventional methods.
- Designed to **endure structural challenges** such as building frame lateral displacement, beam and floor deflection, column shortening and long-term creep.
- **Eliminates corrosion** by utilizing corrosion-proof and rust-proof materials.
- Specially formulated precast concrete mix provides a **maintenance-free, waterproof** panel that minimizes vapor infiltration.
- Major cost savings on **cantilevered** structure designs.

*"I started the trend of using SLENDERWALL® on high rise buildings in New York City. I think that the SLENDERWALL® system will be used on many buildings in New York in the future."*



H. Thomas O'Hara  
H. Thomas O'Hara Architect, PLLC



*"What attracted us to this product is the 2" thick precast concrete in an economical panelized format with steel-stud backup. This significantly reduced the cost of the structural frame and foundation required to support this much lighter system."*

*Thus, we could achieve the beauty of a precast concrete or masonry exterior in a more cost-effective and efficient manner.*

*Currently we are on our fifth project using SLENDERWALL®."*



Edward N. Rothe, FAIA  
Rothe-Johnson-Fantacone



The **SLENDERWALL®** panel system allows the design freedom to create a lasting impression.



- Uses **time-tested, proven** components.
- Provides the **permanence** of architectural precast concrete. It will not dent, rust, burn, warp or delaminate.
- Offers **custom shapes and sizes**, radii, bull noses, reveals and returns manufactured to tight tolerances in year-round climate-controlled factories.
- Designed for **load-bearing** or **curtain wall** applications.

# SLENDERWALL® *Designed for New Construction and Renovation*



Hock Plaza II  
Durham, NC

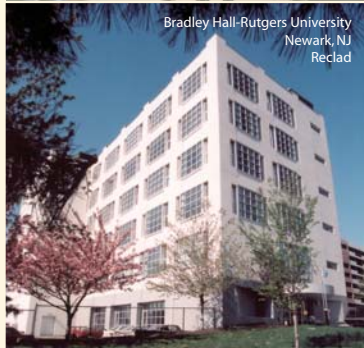

Bradley Hall-Rutgers University  
Newark, NJ  
Reclad



New Jersey Institute of Technology  
Newark, NJ  
Left: New construction  
Right: Reclad

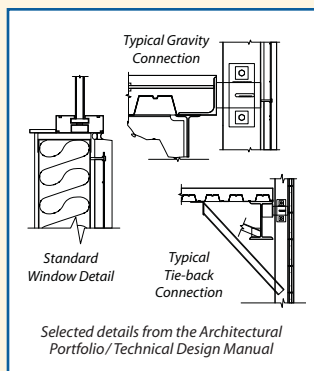

The **SLENDERWALL®** panel system is a permanent, lightweight, cost-and-time-saving exterior wall system.

- **Eliminates** staggering recladding costs and responsibility battles by using permanent components.
- **Lightweight panels** are only 30 lbs. per square foot, including the heavy-gauge steel framing.
- **Reduces installation time and costs** by up to 50% due to exclusive **Lift-and-Release™** panel-landing system.
- **Reduces construction costs** because smaller cranes can be used during installation.
- **Reduces on-site weather costs** and delays as well as on-site construction debris.
- **Reduces shipping costs** by 60% since more lightweight panels can be shipped on each load.
- **Increases leasable floor space income** by mounting panels outboard of floor slab.



Jefferson at Thomas Circle  
Luxury Apartments  
Washington, DC

## Finishes

Choose from a wide variety of **standard** and **custom colors and concrete finishes** for the 2-inch thick exterior precast concrete surface. Individual panels can contain architectural details and **multiple finishes**.



\* **Second Nature™** is the only precast concrete brick reproduction approved by historical societies and architects for use on high profile architectural projects.

# SLENDERWALL®

www.slenderwall.com

Call today to qualify for your free copy of the **SLENDERWALL® Architectural Portfolio/ Technical Design Guide** (308 pages).

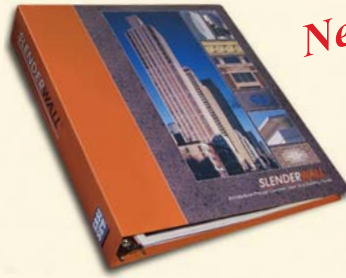

**New!**

## ARCHITECTURAL TESTING INC.

All tests performed by certified independent testing laboratory using nationally recognized standards and methods.

*Earthquake, hurricane and tornado level testing establishes SLENDERWALL® as the wall system of choice for severe conditions.*

- ✓ Preload at 50% design ..... ASTM E330
- ✓ Air Infiltration ..... ASTM E283
- ✓ Static Pressure Water Resistance ..... ASTM E331
- ✓ Dynamic Pressure Water Resistance ..... AAMA 501.1
- ✓ Structural Performance ..... ASTM E330
- ✓ Seismic Movement (Interstory) ..... AAMA 501.4
- ✓ Thermal Cycle ..... AAMA 501.5
- ✓ Thermal Transmittance ..... AAMA 1503
- ✓ Sound Transmission ..... ASTM E90
- ✓ In-situ Water Test ..... AAMA 503.03
- ✓ Fire Resistance Rating ..... ASTM E119

**DURAFLEX 360°** technology used on all tests.

*Detailed report for 60 psf windload SLENDERWALL® panels available upon request along with 12 additional test methods.*

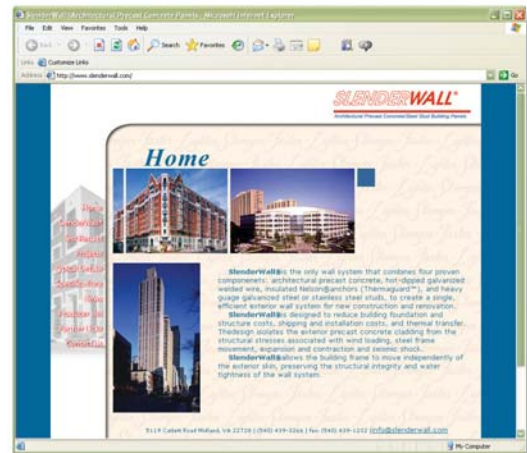

### Visit [www.SlenderWall.com](http://www.SlenderWall.com) for:

- CAD and PDF drawings
- Product information
- Project Summaries and Gallery
- Specifications

### Become a Registered Member:

- Download AutoCAD files
- View Technical Information

**SLENDERWALL®** is backed by the technical expertise, manufacturing strength and installation services of more than 45 years of experience by Smith-Midland® Corporation and Easi-Set® Industries.

Call today to discuss **SLENDERWALL®** ... your exterior architectural precast concrete panel solution.

### Affiliations:



See us in Sweets



Manufactured locally by:



5119 Catlett Road • PO Box 400 • Midland, VA 22728 • (800) 547-4045 • (540) 439-8911 • fax: (540) 439-2541  
[www.easiset.com](http://www.easiset.com) • [www.slenderwall.com](http://www.slenderwall.com) • [info@easiset.com](mailto:info@easiset.com)

EASI-SET® Industries is a licensor of precast products worldwide, and a wholly owned subsidiary of SMITH-MIDLAND® Corporation, a publicly traded company. Copyright 2007 by EASI-SET® Industries. All rights reserved. Printed in USA.